

2.2 EXTERIOR SECTION (1/2)

A

Refer to "2.3 Exterior (2/2) section".

TLXJ Type Only

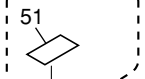

WYXJ Type Only

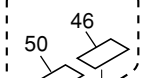

B

C

D

E

F

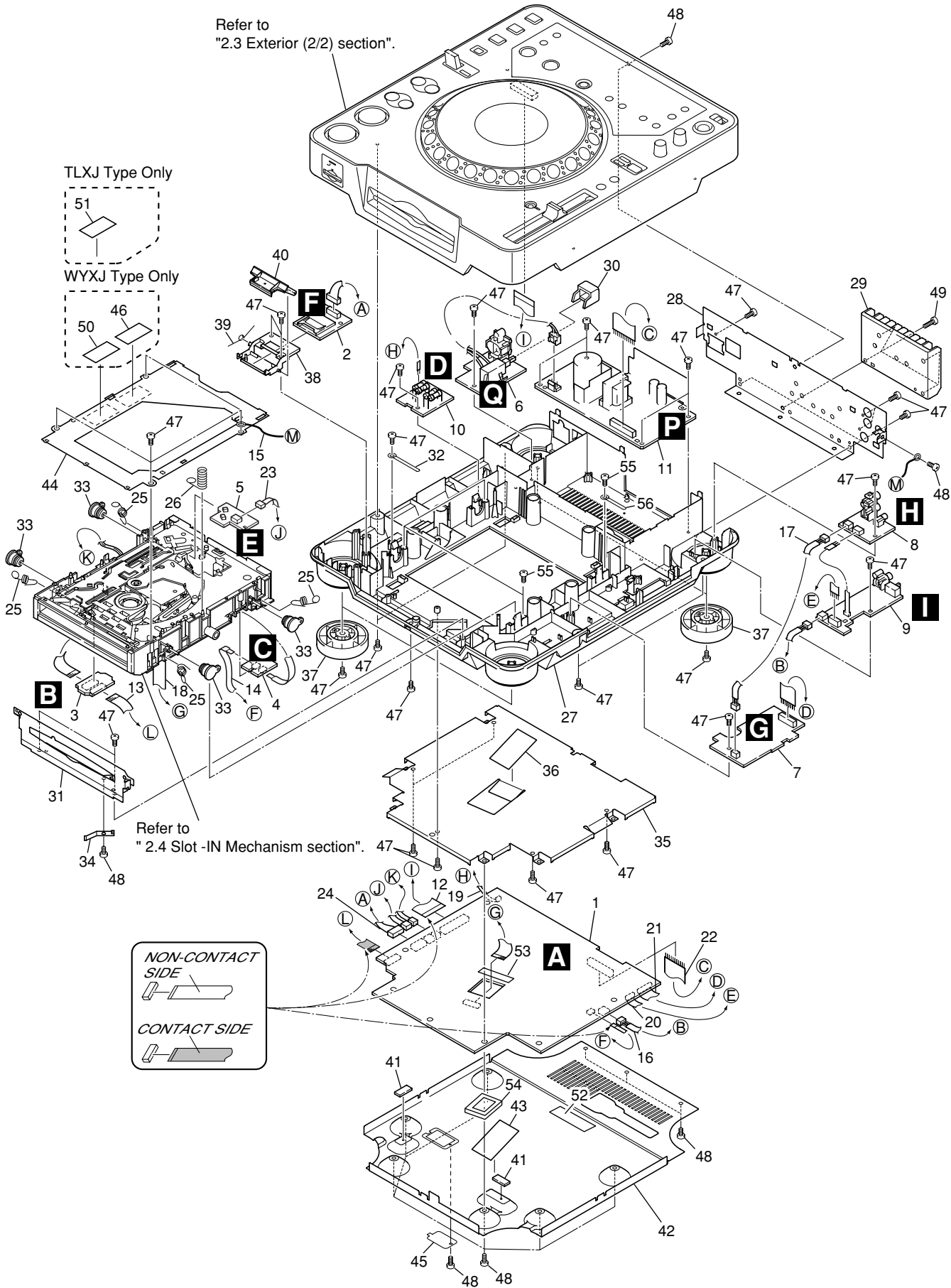

Refer to "2.4 Slot -IN Mechanism section".

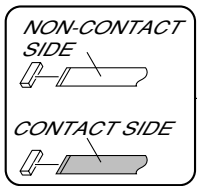

EXTERIOR SECTION (1/2) Parts List

Mark	No.	Description	Part No.	Mark	No.	Description	Part No.
	1	MAIN Assy	DWX2303		30	Power Knob	DAC1895
	2	MCCB Assy	DWX2304		31	Front Plate	DNH2480
	3	SPCN Assy	DWX2170		32	Cord Clamper	RNH-184
	4	STCN Assy	DWX2171		33	Damper	CNV6011
	5	SLMB Assy	DWX1309		34	Earth Plate (CU)	VBK1070
	6	PSWB Assy	See Contrast Table(2)		35	Shield Case	DNH2481
	7	DABB Assy	DWX2305		36	Shield Cushion	DEC2445
	8	JACB Assy	DWX2306		37	Insulator Assy	DXA1904
	9	DOUT Assy	DWX2307		38	Memory Holder	DNK3884
	10	FLRB Assy	DWX2308		39	Flap Spring	DBH1487
	11	SW POWER SUPPLY Assy	DWR1370		40	SD Flap	DNK3883
	12	25P Flexible Cable/60V	DDD1196		NSP 41	Silicone Rubber D5L	DEB1456
	13	12P Flexible Cable/60V	DDD1197		42	Bottom Plate 2	DNH2558
	14	4P Flexible Cable/60V	DDD1198		43	Bottom Cushion	DEC2444
	15	Earth Lead Unit/300V	DDF1024		44	Mecha Plate	DNH2339
	16	Connector Assy 3P	DKP3562		45	Bottom Cover	DNH2559
	17	Connector Assy 6P	DKP3654		46	Caution Label	See Contrast Table(2)
	18	FPC D5 Slot	DNP1948		47	Screw	BPZ30P080FZK
	19	Jumper Wire 03P	D20PYY0310E		48	Screw	BBZ30P060FZK
	20	Jumper Wire 05P	D20PYY0510E		49	Screw	BBZ30P120FZK
	21	Jumper Wire 09P	D20PYY0910E		50	Caution Label HE	See Contrast Table(2)
	22	Jumper Wire 15P	D20PYY1510E		51	Caution Label	See Contrast Table(2)
	23	Connector Assy	PF03PP-B30		52	65 Label	See Contrast Table(2)
	24	Connector Assy	PF09PP-D15		53	Protect Sheet	DEC2559
	25	Float Spring (G5)	DBH1494		54	PU Packing	DEC2593
	26	Earth Spring	DBH1398		55	Screw	SBPZ30P140FMC
	27	Chassis	DNK3869		56	Cord Clamper	ZCB-069Z
NSP	28	Rear Panel	See Contrast Table(2)				
	29	Heat Sink	DNG1082				

(2) CONTRAST TABLE

CDJ-1000MK2/KUCXJ, TLXJ and WYXJ types are constructed the same except for the following:

Mark	No.	Symbol and Description	Part No.		
			KUCXJ type	TLXJ type	WYXJ type
NSP	6	PSWB Assy	DWS1312	DWS1311	DWS1311
	28	Rear Panel	DNC1647	DNC1648	DNC1646
	46	Caution Label	Not used	Not used	VRW1094
	50	Caution Label HE	Not used	Not used	PRW1233
	51	Caution Label	Not used	PRW 1018	Not used
	52	65 Label	ARW7050	Not used	Not used

2.3 EXTERIOR SECTION (2/2)

A

B

C

D

E

F

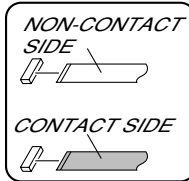
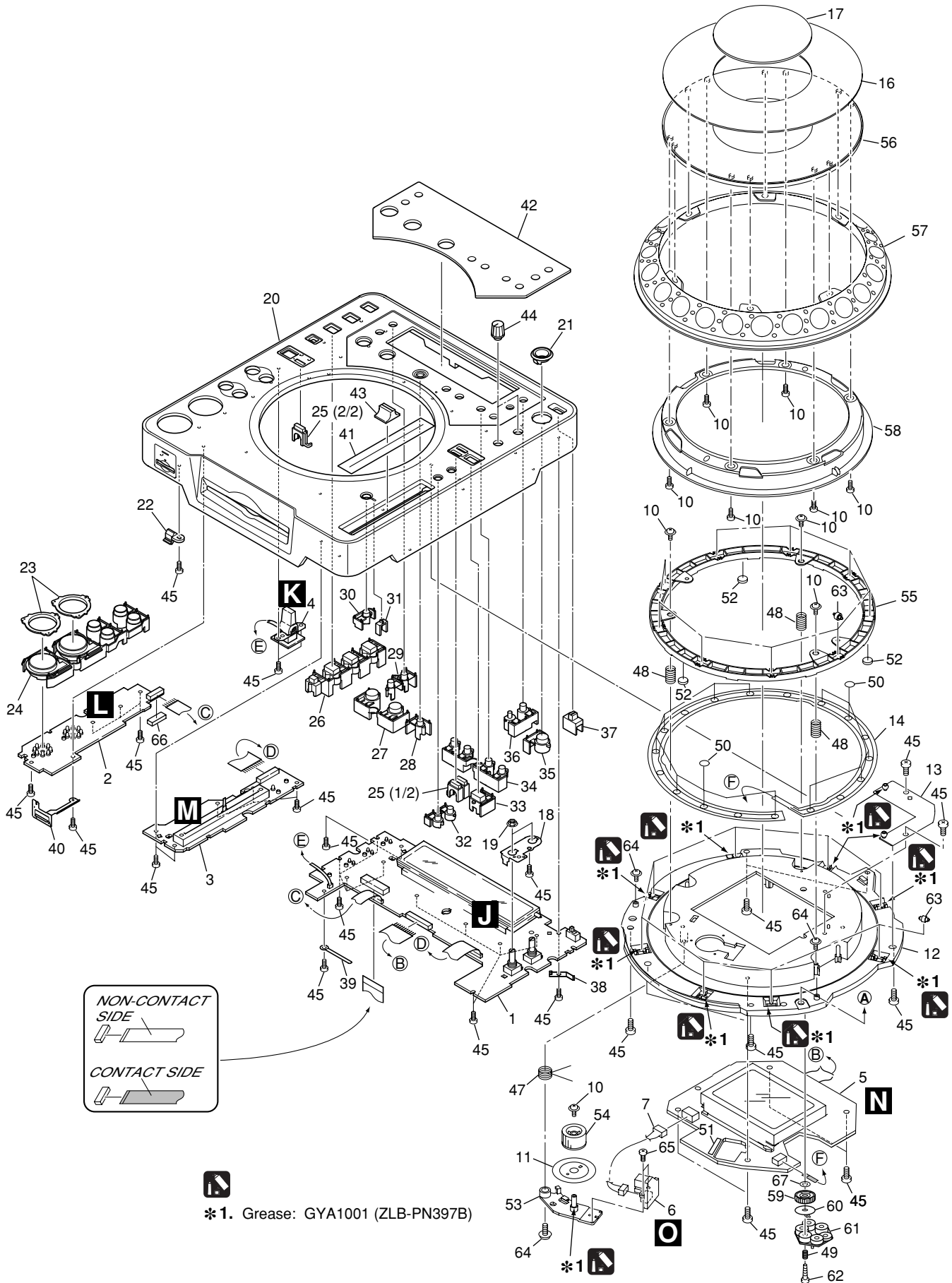

***1.** Grease: GYA1001 (ZLB-PN397B)

EXTERIOR SECTION (2/2) Parts List

<u>Mark No.</u>	<u>Description</u>	<u>Part No.</u>	<u>Mark No.</u>	<u>Description</u>	<u>Part No.</u>
1	MFLB Assy	DWG1567	51	Spacer	DEC2554
2	KSWB Assy	DWS1324	52	Ring Cushion	DEC2604
3	SLDB Assy	DWS1325	53	Gear Arm	DNK4065
4	RSWB Assy	DWS1310	54	D Gear	DNK4066
5	JFLB Assy	DWG1568	55	SW Ring	DNK4070
6	JOGB Assy	DWG1569	56	JOG A	DNK4172
7	Connector Assy	PF04PP-B07	57	JOG B	DNK4173
8		58	JOG C	DNK4174
9		59	Gear	DNK4176
10	Screw	PBA1062	60	Smoother	DNK4177
11	Encoder Plate	DEC2498	61	ADJ Plate	DNK4178
12	JOG Holder 2	DNK4175	62	Screw	BPZ20P100FMC
13	JOG Stay Assy	DXB1780	63	Roller A Assy	DXB1773
14	Sheet SW	DSX1060	64	Screw	IPZ30P100FMC
15		65	Screw	BPZ20P060FMC
16	JOG Plate	DAH2052	66	FFC Guard	DEC2586
17	JOG Panel	DAH2182	67	Washer	WA42D080D050
18	VR Stay	DNF1663			
19	Flange Nut (M9)	DBN1004			
20	Control Panel	DNK4180			
21	Eject Guard	DNK3958			
22	Card Lens	DNK3885			
23	Ring Lens	DNK3880			
24	Set Knob (PLAY) Assy	DXB1762			
25	Mode Lens	DNK3881			
26	Set Knob (HS)	DAC1986			
27	Set Knob (LOOP)	DAC1995			
28	Re-loop Knob	DAC1992			
29	Set Knob (TIME)	DAC1991			
30	Tempo Reset Knob	DAC1993			
31	Tempo Lens	DNK3882			
32	Set Knob (MT)	DAC1987			
33	Mode Select Knob	DAC1989			
34	Set Knob (SC)	DAC1988			
35	Eject Knob	DAC1990			
36	Set Knob (MEMO)	DAC1994			
37	Slide SW Knob	DAC1926			
38	Earth Plate (CU)	VBK1070			
NSP 39	Cord Clamper	ZCB-069Z			
40	Card Plate	DBK1212			
41	Slide Sheet 1C	DAH1988			
42	Display Panel	DAH2022			
43	Slide Knob	DNK2936			
44	Rotary Knob C	DAA1143			
45	Screw	BPZ30P080FZK			
46				
47	Arm Spring	DBH1503			
48	SW Spring 25	DBH1514			
49	Gear Spring 200	DBH1525			
50	SW Cushion HH48/2	DEC2538			