

# 9. EXPLODED VIEWS AND PARTS LIST

- NOTES:
- Parts marked by "NSP" are generally unavailable because they are not in our Master Spare Parts List.
  - The  $\triangle$  mark found on some component parts indicates the importance of the safety factor of the part. Therefore, when replacing, be sure to use parts of identical designation.
  - Screws adjacent to  $\nabla$  mark on product are used for disassembly.
  - For the applying amount of lubricants or glue, follow the instructions in this manual. (In the case of no amount instructions, apply as you think it appropriate.)

## 9.1 PACKING SECTION

**Note \*1:** For the shipment position of each knob, refer to "[1] Knobs and Buttons Location" of 7. DISASSEMBLY.

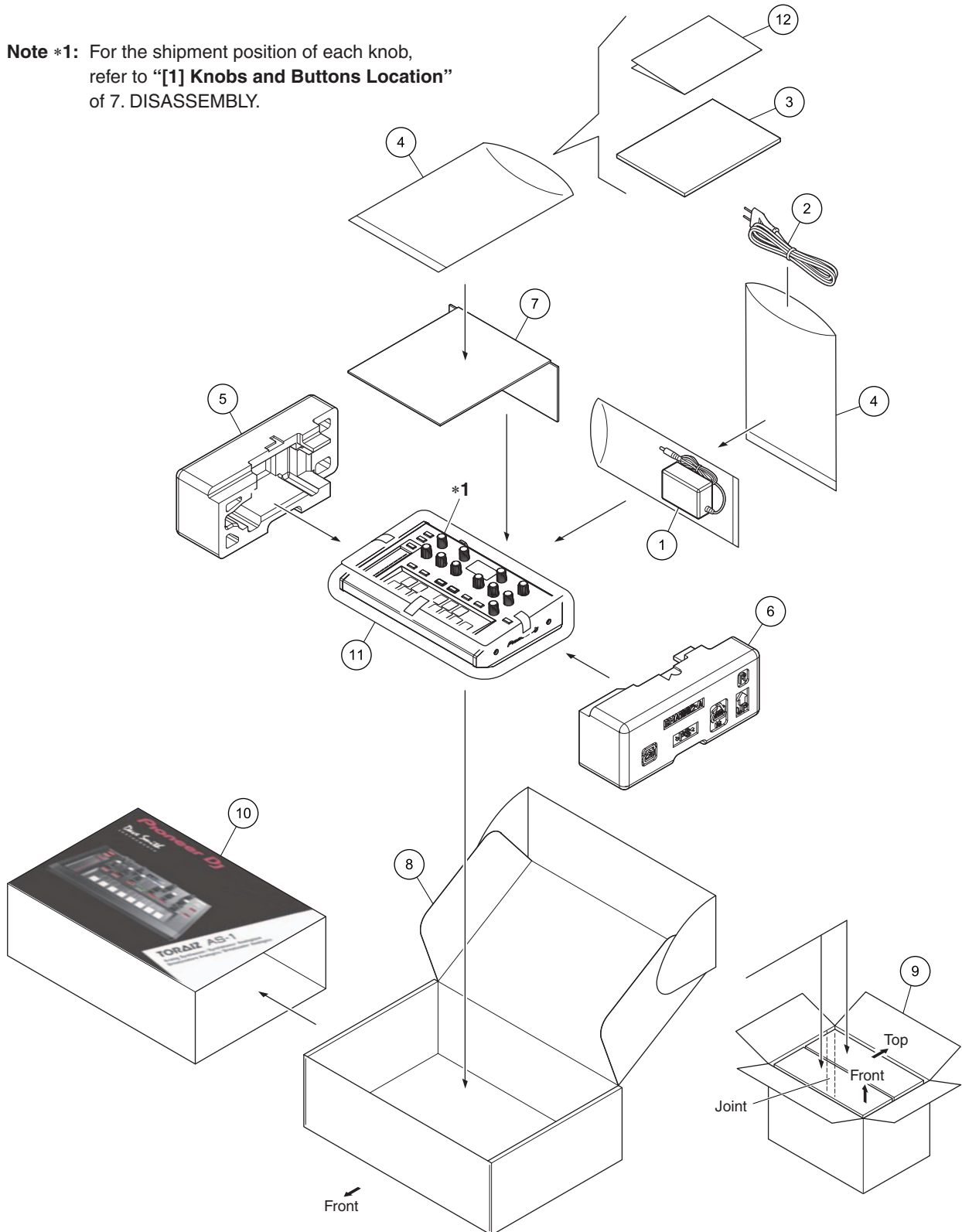

**(1) PACKING SECTION PARTS LIST**

<u>Mark No.</u>	<u>Description</u>	<u>Part No.</u>
A	⚠ 1 AC Adapter	See Contrast table (2)
	⚠ 2 AC Power Cord	See Contrast table (2)
	3 Operating Instructions (Quick Start Guide)	See Contrast table (2)
NSP	4 Polyethylene Bag	AHG7117
	5 Packing Pad	DHA1961
	6 Packing Pad	DHA1962
	7 Partition	DHC1098
	8 Packing Case	See Contrast table (2)
	9 Master Carton	See Contrast table (2)
B	10 Packing Case	DHG3548
	11 Mirror Mat	DHL1204
NSP	12 Warranty	See Contrast table (2)

**(2) CONTRAST TABLE**

SYXJ, UXJCB and FWLPWXJ are constructed the same except for the following:

Mark	No.	Symbol and Description	SYXJ	UXJCB	FWLPWXJ
C	⚠ 1	AC Adapter	DWR1558	DWR1558	DWR1550
	⚠ 2	AC Power Cord	ADG1154	XDG3052	ADG1154
	3	Operating Instructions (Quick Start Guide)	DRH1418	DRH1420	DRH1421
	8	Packing Case	DHG3526	DHG3550	DHG3551
	9	Master Carton	DHG3527	DHG3553	DHG3554
NSP	12	Warranty	DRY1270	Not used	Not used

# 9.2 EXTERIOR SECTION

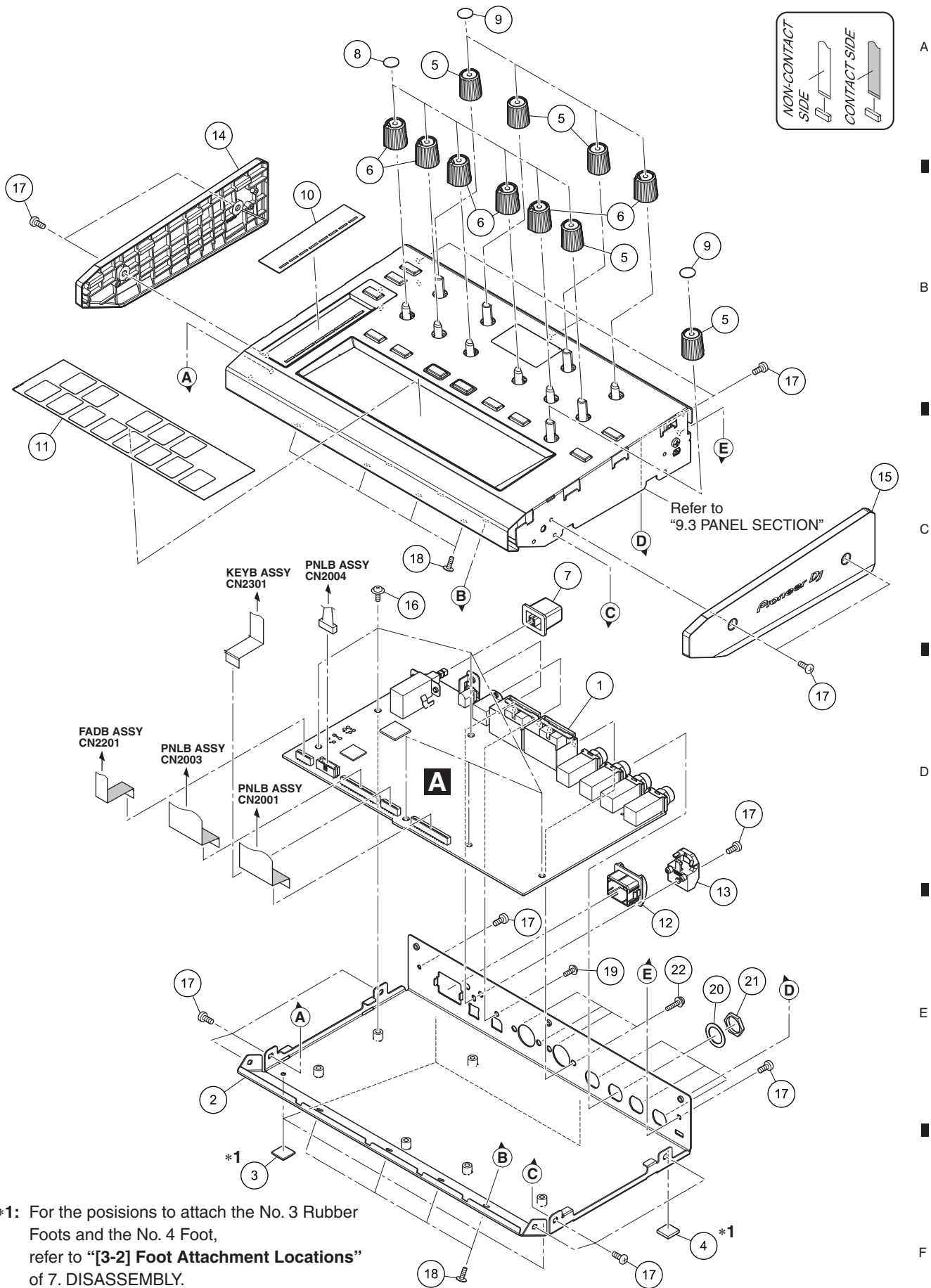

### EXTERIOR SECTION PARTS LIST

<u>Mark No.</u>	<u>Description</u>	<u>Part No.</u>
A 1	MAIN ASSY	DWX3946
2	Chassis	DNA1470
3	Rubber Foot	VEB1349
4	Foot	DEB2056
5	Knob	DAA1376
6	Knob	DAA1377
7	Power Knob	DAC2306
8	Sheet	DAH3136
9	Sheet	DAH3137
10	Sheet	DEC3662
B 11	Sheet	DEC3730
12	Power Knob Guard	DNK4534
13	Hook	DNK6679
14	Panel	DNK6675
15	Panel	DNK6676
16	Screw	AMZ30P060FTC
17	Screw	BBT30P060FTB
18	Screw (Fe)	DBA1290
19	Screw (M3x5)	DBA1340
20	Washer	DEC2920
C 21	Nut (M12)	NKX2FNI
22	Screw	PMH30P100FTB

# 9.3 PANEL SECTION

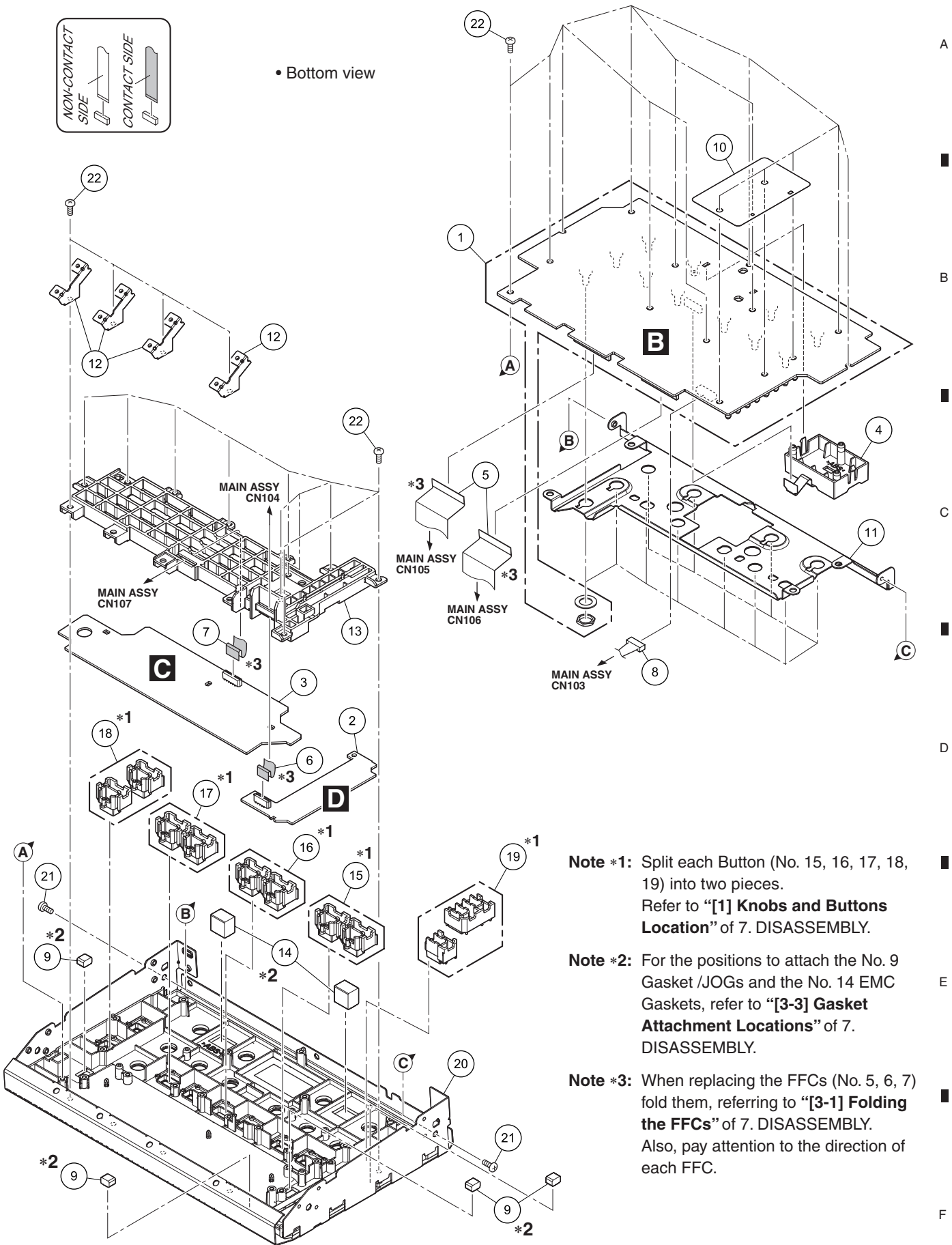

PANEL SECTION SECTION PARTS LIST

<u>Mark No.</u>	<u>Description</u>	<u>Part No.</u>
-----------------	--------------------	-----------------

A

1	PNLB ASSY	DWX3950
2	FADB ASSY	DWX3951
3	KEYB ASSY	DWX3952
4	OLED ASSY	DEA1071
5	FFC /30P	DDD1593

6	FFC	DDD1800
7	FFC	DDD1801
8	Connector ASSY	PF06PP-D10
9	Gasket /JOG	DEC3562
10	Sheet	DEC3734

B

11	Stay	DNF2015
12	Plate	DNF2016
13	Holder	DNK6680
14	EMC Gasket	DEC3738
15	Button	DAC3264

16	Button	DAC3265
17	Button	DAC3266
18	Button	DAC3267
19	Button	DAC3268
20	Panel ASSY	DEA1070

C

21	Screw	BBT30P060FTB
22	Screw	BPZ30P080FNI

D

E

F

# 12. PCB PARTS LIST

- NOTES:**
- Parts marked by "NSP" are generally unavailable because they are not in our Master Spare Parts List.
  - The  $\Delta$  mark found on some component parts indicates the importance of the safety factor of the part. Therefore, when replacing, be sure to use parts of identical designation.
  - When ordering resistors, first convert resistance values into code form as shown in the following examples.

Ex.1 When there are 2 effective digits (any digit apart from 0), such as 560 ohm and 47 k ohm (tolerance is shown by J = 5%, and K = 10%).

560  $\Omega$   $\rightarrow$  56  $\times 10^1$   $\rightarrow$  561 ..... RD1/APU  $\boxed{5}$   $\boxed{6}$   $\boxed{7}$  J  
 47 k $\Omega$   $\rightarrow$  47  $\times 10^3$   $\rightarrow$  473 ..... RD1/APU  $\boxed{4}$   $\boxed{7}$   $\boxed{3}$  J  
 0.5  $\Omega$   $\rightarrow$  R50 ..... RN2H  $\boxed{R}$   $\boxed{5}$   $\boxed{0}$  K  
 1  $\Omega$   $\rightarrow$  1R0 ..... RS1P  $\boxed{7}$   $\boxed{R}$   $\boxed{0}$  K

Ex.2 When there are 3 effective digits (such as in high precision metal film resistors).

5.62 k $\Omega$   $\rightarrow$  562  $\times 10^1$   $\rightarrow$  5621 ..... RN1/4PC  $\boxed{5}$   $\boxed{6}$   $\boxed{2}$   $\boxed{1}$  F

Mark	No.	Description	Part No.	Mark	No.	Description	Part No.
------	-----	-------------	----------	------	-----	-------------	----------

## LIST OF ASSEMBLIES

	1..MAIN ASSY	DWX3946
NSP	1..SUB ASSY	DWM2642
	2..PNLB ASSY	DWX3950
	2..FADB ASSY	DWX3951
	2..KEYB ASSY	DWX3952

Mark	No.	Description	Part No.
------	-----	-------------	----------

## A MAIN ASSY

### SEMICONDUCTORS

NSP	IC	101 Flash Memory IC	W25Q16DVSSIG
NSP	IC	102 U-PRO IC	PIC32MX270F512LIPF
	IC	201 AUD DSP SYS LSI	ADSP-21478KCPZ-1A
	IC	203,303-306,309-312 CONV IC	AK4386ET
	IC	204 Logic IC	74LCX04FT
	IC	301 CONV IC	AK4556VT
	IC	302,403,503,702 OP AMP IC	NJM062CAG
	IC	307,308,313,314 OP AMP IC	NJM064CG
$\Delta$	IC	401,402 Regulator IC	MM1431AN
	IC	404,504 OP AMP IC	NJMOP1772E
	IC	405 Analog SW IC	CD74HCT4053PW
	IC	406,408,506,508 OP AMP IC	NJM064CG
	IC	407,507 Comparator IC	NJM311M
	IC	410 Logic IC	SN74LVC1G80DCK
	IC	411,511,602,801 IC	V2164M-M
	IC	601,701,802,1001 OP AMP IC	NJM064CG
	IC	703 IC	NJM13700M
	IC	803 Comparator IC	NJU7119F3
	IC	904 OP AMP IC	NJM062CAG
	IC	1002 Driver IC	LM4881M
$\Delta$	IC	1101 IC	BD9851EFV
$\Delta$	IC	1102,1106 Regulator IC	LM337KVUG3
$\Delta$	IC	1103 Regulator IC	BDJ2FC0WEFJ
$\Delta$	IC	1104 IC	NJM2856DL3-33
$\Delta$	IC	1105 IC	NJM2886DL3-33
$\Delta$	IC	1107 Regulator IC	BD00IC0WEFJ
$\Delta$	IC	1108 IC	NJM2886DL3-05
	Q	101 Resistor Built-IN TR	LTA023JEB

Q	102 Resistor Built-IN TR	LTC024EEB	
Q	401,402,501,701 Bipolar TR	HN1C01FUS1	
Q	403,502 FET	MMBF4391LG	
Q	404,503 Chip Transistor	MMST3904	
Q	702,705,708,711 Bipolar TR	HN1A01FUS1	
Q	703,704,706,707 Bipolar TR	HN1C01FUS1	
Q	709,710,712-715 Bipolar TR	HN1C01FUS1	
Q	716 Bipolar TR	HN1A01FUS1	
Q	1001 Resistor Built-IN TR	LTC024EEB	
Q	1002 Resistor Built-IN TR	LTC024EEB	
Q	1003,1010,1105 Bipolar TR	LSCR523UB	
Q	1004,1108 Bipolar TR	LSAR523UB	
Q	1005,1006 Chip Transistor	INC2002AC1	
Q	1007 Bipolar TR	HN1C01FUS1	
Q	1008 Resistor Built-IN TR	LTC024EEB	
Q	1009 Resistor Built-IN TR	LTC024EEB	
$\Delta$	Q	1101,1102,1106 FET	RSQ035P03
$\Delta$	Q	1103 FET	RTQ045N03
Q	1104 Resistor Built-IN TR	LTC024EEB	
Q	1107 Resistor Built-IN TR	LTA024EEB	
Q	1109 Bipolar TR	LSCR523UB	
D	101,102 ESD Protector	EZAEG2N50A	
D	104 Zener Diode	DZ2J051M0	
D	401-405,501 Rectifier Diode	DA2J101	
D	502-505,701 Rectifier Diode	DA2J101	
D	702,1001 Rectifier Diode	DA2J101	
D	1002,1003 Rectifier Diode	DA2J101	
D	1004 Diode	RB160M-30	
D	1005,1006 Schottky Diode	RB501VM-40	
$\Delta$	D	1101,1105 Schottky Diode	DB2J41100
$\Delta$	D	1102 Diode	RB060M-30
D	1103 Zener Diode	DZ2J062M0	
D	1104,1106 Rectifier Diode	DA2J101	

### MISCELLANEOUS

L	1101,1103 Power Inductor	ATH7011	
L	1109 Common Mode Coil	ATF7043	
L	1110 Chip Ferrite Bead	DTL1128	
L	1112,1113 Choke Coil	DTH1216	
X	101 Oscillator	CWX4026	
X	201 Oscillator	CWX4008	
F	1001,1002,1005 EMI Filter	CCG1267	
F	1006,1008-1011 EMI Filter	CCG1267	
$\Delta$	P	1101 Protector(4.000A)	DEK1104
$\Delta$	P	1102 Protector(1.250A)	DEK1098

Mark	No.	Description	Part No.
A	P	1103 Protector(3.000A)	DEK1103
	PC	1001 Photo Coupler	TLP2368
	S	1101 Switch	DSA1037
	SN	101 Temperature Sensor	S-58LM20A-N4U
	VA	1101 Varistors	EZJZ1V270RM
	CN	103 Connector	AKM1277
	CN	104 Connector	CKS3851
	CN	105,106 Connector	CKS3871
	CN	107 Connector	CKS3853
	JA	101 USB Connector	DKN1237
B	JA	1001-1003,1006 6.5 DIA Jack	DKN1653
	JA	1004,1005 Connector	DKN1188
	JA	1101 DC-IN Jack	DKN1523

Mark	No.	Description	Part No.
R	1124		RS1/10SR1203D
R	1125		RS1/10SR333J
R	1127		RS1/10SR2002D
R	1128		RS1/10SR224J
R	1131		RS1/10SR473J
R	1132,1134		RS1/10SR1200D
R	1133,1150		RS1/10SR5100D
R	1135		RS1/10SR3600D
R	1136		RS1/10SR7501D
R	1137		RS1/10SR1502D
R	1148		RS1/10SR5101D
R	1152,1157		RS1/4SA2R7J
R	1153,1154		RS1/10SR223J
R	1156		RS1/10SR101J
		Other Resistors	RS1/10SR####F

**RESISTORS**

**CAPACITORS**

R	101,102	RS1/10SR330J
R	103	RS1/10SR1001F
R	104	RS1/10SR103J
R	106	RS1/10SR102J
R	107-109,111,112,118,122	RS1/10SR470J
R	114,115	RS1/10SR0R0J
R	120,121,126-128,130-134	RS1/10SR101J
R	123,129,137,142,143	RS1/10SR470J
R	124,125,135,138,141,144	RS1/10SR680J
R	136,139,140,148,153-158	RS1/10SR101J
R	145-147,149,210,213-219	RS1/10SR680J
R	150	RS1/10SR103J
R	152,161	RS1/10SR0R0J
R	160,166,224-226	RS1/10SR101J
R	162,165,233-236	RS1/10SR470J
R	204,205	RS1/10SR4700F
R	207	RS1/10SR4701F
R	208,211,212	RS1/10SR330J
R	220-223,371	RS1/10SR680J
R	231,232	RS1/10SR2002F
R	392	RS1/4SA0R0J
R	423,513	DCN1205
R	464,465,1022,1023,1027	RS1/10SR223J
R	471-474	RS1/10SR121J
R	475-478	RS1/10SR151J
R	549,550,1021,1025	RS1/10SR0R0J
R	1014,1039	RS1/10SR103J
R	1015-1017	RS1/4SA221J
R	1019	RS1/10SR470J
R	1028,1033,1034	RS1/10SR183J
R	1029,1111	RS1/10SR472J
R	1030,1120,1121	RS1/10SR473J
R	1031,1035,1036,1040	RS1/10SR223J
R	1038,1110	RS1/10SR104J
R	1101,1106	RS1/10SR1502D
R	1102,1105,1122	RS1/10SR1002D
R	1104	RS1/10SR1503D
R	1107,1114	RS1/10SR3002D
R	1109,1113	RS1/10SR100J
R	1112,1129	RS1/4SA0R0J
R	1115	RS1/10SR103J
R	1116	RS1/10SR105J
R	1117	RS1/10SR6201D
R	1119,1123,1126	RS1/10SR0R0J

C	101,104,106-110,112,113	CKSRYB104K16
C	105	CKSRYB105K10
C	111,114	DCH1201
C	115,117-119,129,132,134	CKSRYB104K16
C	116,120-125	CCSRCH102J50
C	133	CKSRYB104K25
C	201-207,209,211	CKSRYB103K50
C	208,210,212-216,218,220	CKSRYB104K16
C	217,219,226,227,231,233	DGH1201
C	221-224,228,229,232,236	CKSRYB104K16
C	234,235,302,303,305,309	DGH1201
C	301,304,313-316,329	CKSRYB104K16
C	306	CKSQB225K16
C	307,308,321-324,337	CKSRYB104K25
C	310-312,317-320,325-328	DGH1201
C	330-332,402,405,406,408	CKSRYB104K16
C	333-336	DGH1201
C	338-340	CKSRYB104K25
C	401,404	DGH1354
C	403,415	CCSRCH102J50
C	407,503	CCG1393
C	409,504	CCSRCH101J50
C	410,420,501,502,505	CKSRYB104K16
C	411,506	DGG1069
C	412,507	DGH1263
C	413,416,508	CCSRCH470J50
C	414,417-419,421,509-512	CCSRCH561J50
C	601,605	CCSRCH102J50
C	602,606	CKSRYB103K50
C	603,607,611,613,702,703	CKSRYB104K25
C	604,608,801	DGG1065
C	609,610,614	CCSRCH101J50
C	612,802,804	CCSRCH561J50
C	701	DGH1263
C	704,706,716,717	DGG1066
C	705,709,712,713	DGG1068
C	707	DGH1352
C	708	CCSRCH181J50
C	710,711,714,715,805-807	CKSRYB104K25
C	803,808	DGG1067
C	809,810,1019	CKSRYB104K25
C	811,1016	DGG1065



Mark	No.	Description	Part No.
C	812,901		CCSRCH561J50
C	813,1010,1017,1018,1020		CKSRYP104K16
C	903,1102		CCSRCH101J50
C	1001,1002		CCG1393
C	1003,1006		CCSRCH471J50
C	1004,1005		CCSRCH330J50
C	1007,1008		CCSRCH100D50
C	1009,1101,1104,1111,1112		CKSRYP105K10
C	1011,1012		CCSRCH102J50
C	1013,1106,1113		DCH1201
C	1014,1015		DCH1353
C	1024,1035,1108,1110,1123		CKSRYP104K25
C	1036		DCH1263
C	1103		CKSRYP332K50
C	1105		ACE7114
C	1107		CCSRCH221J50
C	1109,1125		CCG1236
C	1114,1127,1136		CKSRYP102K50
C	1115,1121,1128,1133,1134		CCG1393
C	1116,1140,1141		CKSRYP105K10
C	1117,1118		CKSQYB225K16
C	1119,1130		CEHVW470M25
C	1120		CKSRYP682K50
C	1122,1124,1137,1142,1143		CKSRYP103K50
C	1126		CKSRYP104K25
C	1129		CCSRCH222J50
C	1132,1149		CCH1565
C	1135,1144,1145,1148,1150		DCH1201
C	1138,1139		DCH1263
C	1146,1154		CCG1393
C	1147		CKSRYP102K50
C	1151,1155		DCH1201
C	1153		CCSRCH471J50
C	1156		CKSRYP105K10
C	1160		CKSRYP103K50

## **B** PNLB ASSY

### SEMICONDUCTORS

IC	2001 Logic IC	74LCX541FT
Q	2001-2011,2014 Bipolar TR	HN1C01FUS1
Q	2012 Resistor Built-IN TR	LTC024EEB
△	Q 2013 FET	SSM3J331R
Q	2015 Bipolar TR	LSCR523UB
D	2001-2011,2013-2019 LED	LTL17KRH5D
D	2012 LED	LTL17KCGP4J
D	2020 Schottky Diode	RB501VM-40
D	2022 Zener Diode	DZ2J033M0
D	2023 Rectifier Diode	DA2J101
D	2025-2034 Switching Diode	DAP202UM

### MISCELLANEOUS

S	2001-2011 Tact Switch	DSG1079
S	2013-2017 Rotary Encoder	DSX1131
VR	2001-2006 Rotary VR	DCS1135
CN	2001,2003 Connector	CKS3871
CN	2002 Connector	CKS5657

Mark	No.	Description	Part No.
CN	2004	L-plug(6P)	KM200NA6L

### RESISTORS

R	2075	RS1/10SR1004F
R	2101-2104	RS1/4SA0R0J
R	2107-2110	RS1/4SA331J
	Other Resistors	RS1/10SR###J

### CAPACITORS

C	2001,2011	CKSRYP104K16
C	2002-2006,2009,2013,2014	CKSRYP105K10
C	2007,2020	CKSRYP104K25
C	2008	DCG1065
C	2010	ACG1147
C	2015	CCG1393
C	2016	DCH1352

## **C** KEYB ASSY

### SEMICONDUCTORS

IC	2301,2303 CDC IC	AD7147ACPZ500RL7
IC	2302,2304 Logic IC	TC7SH08FUS2
D	2301,2302 Zener Diode	DZ2J036M0

### MISCELLANEOUS

L	2301 Chip Solid Inductor	XTL3010
L	2302 Chip Solid Inductor	XTL3010
CN	2301 Connector	CKS3853

### RESISTORS

	All Resistors	RS1/10SR###J
--	---------------	--------------

### CAPACITORS

C	2301	DCH1201
C	2302-2304,2307-2309	CKSRYP104K16

## **D** FADB ASSY

### SEMICONDUCTORS

IC	2201 CDC IC	AD7147ACPZ500RL7
IC	2202 Logic IC	TC7SH08FUS2
D	2201 Zener Diode	DZ2J036M0

### MISCELLANEOUS

L	2203 Chip Solid Inductor	XTL3010
CN	2201 Connector	CKS3851

### RESISTORS

	All Resistors	RS1/10SR###J
--	---------------	--------------

### CAPACITORS

C	2201	DCH1201
C	2202-2204	CKSRYP104K16